

Universal Switch Kit "USK1-1"

Installation Instructions for Jackson 1085 and 1095

Mount the Marray switch assembly on the back of the hinge style case. Locate the switch assembly as shown and secure the assembly with the self-tapping screws provided.

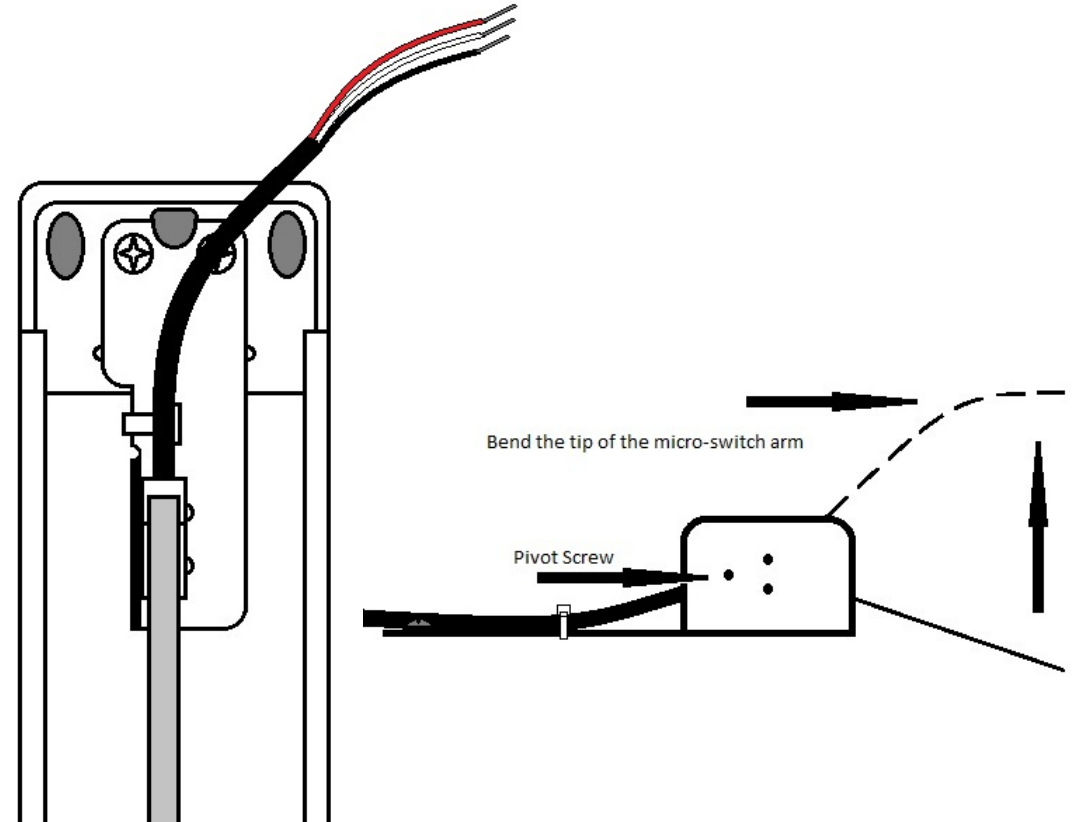
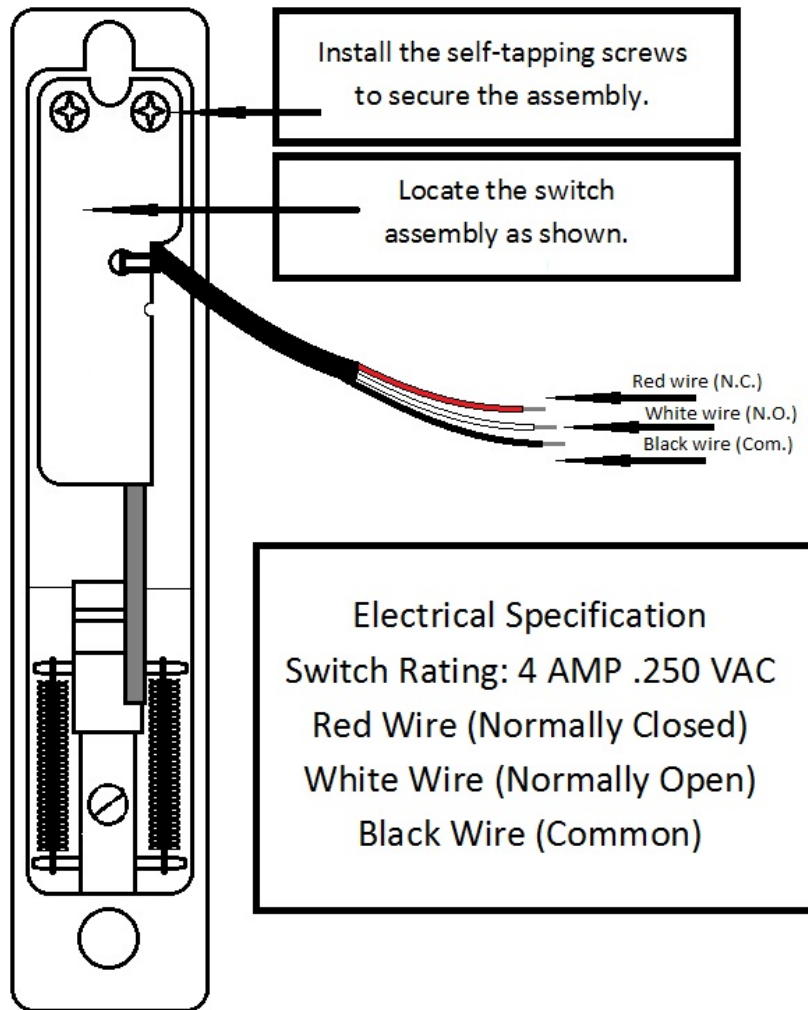

Installation instructions for Adams Rite 8000 series exit bars

Bend the tip of the micro-switch arm slightly with your fingers. Remove the bottom screw and rotate the switch upward. Place the screw in the top hole. Do not remove the pivot screw. Place the wires through the hole in the back of the Adams Rite exit bar. Install the self-tapping screws to secure the assembly.